

Steckbereich nicht nach IEC 1169-36,
nur steckbar mit 852.01.2510.00'

Interface dimensions not according IEC 1169-36,
only mateable with 852.01.2510.00'

Montagebohrung M10:1
Mounting hole S10:1

M/S 5:1

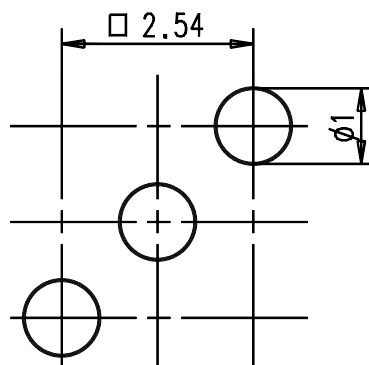
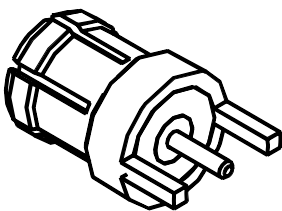

					general tolerance ISO 2768 mH		scale: 10:1	
							Assembly instruction: Stripping dimension:	
					generate	date	name	Stecker p.c.b. plug
					checked		Zech	
					Norm			
					31385			
103/02	b	Text hinzu	16.07.02	IS		851.01.1510.00'		Rev.
	a	Masse ergaenzt	10.09.91	RSc				b
nr.	rev.	alteration	date	name				