

M/s 3:1

M/s 1:1

XX = Measuring point for plating

Metallclip
metal clip

Für Kabel /
For cable

| Gr. | Type | Ø D1 | Ø D2 | Ø D3 | Ø D4 | Ø D5 | Ø D6 | Ø D7 | Ø D8 | Crimp Aussen/out | Innen/in |
|-----|------------------------------|------|------|------|------|------|------|------|------|---------------------|-------------------|
| 1 | RG 178 BU / RG 196 AU | 1,80 | 1,30 | 0,84 | 0,30 | 1,10 | 1,70 | 2,25 | 3,20 | 2,67 | löten / solder |
| 2 | RG 188 AU / RG 316U / RG 174 | 2,50 | 2,00 | 1,52 | 0,51 | 1,70 | 2,60 | 3,20 | 3,80 | 3,25 | löten / solder |
| 3 | | | | | | | | | | | |
| 4 | | | | | | | | | | | |
| 5 | RG 316 D / K 02252d | 2,80 | 2,60 | 1,52 | 0,51 | 1,70 | 2,60 | 3,60 | 4,30 | 3,65 | löten / solder |

| | | | | | | |
|-----------------------|------|---|----------|---|-------------|--------------|
| IMS CONNECTOR SYSTEMS | | general tolerance ISO 2768 mH angle: ±5° | | scale: 10:1 | | |
| | | date name | | Assembly instruction: M6/K3 Stripping dimension: M6/K3 | | |
| generate | | 25.08.83 | Ketterer | | Kabelbuchse | |
| checked | | 13.12.16 | Pölz | | | |
| Norm | | | | Cable mount jack | | |
| EC_027_12 | j | revised | 05.12.16 | MCs | 53.2415.4'' | |
| 320/98 | i | revision stand | 18.06.98 | I.S. | | |
| 119/98 | h | new drawing | 15.05.98 | I.S. | | |
| design | a | 2 measuring points | 11.05.09 | RSch | | |
| nr. | rev. | alteration | date | name | cable code | surface code |

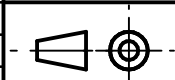

Rev.
j