

Kabelzuschnitt / stripping dimension

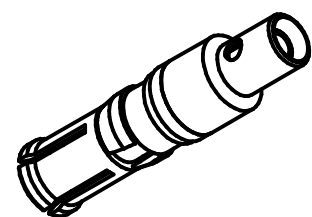

M/s 2:1

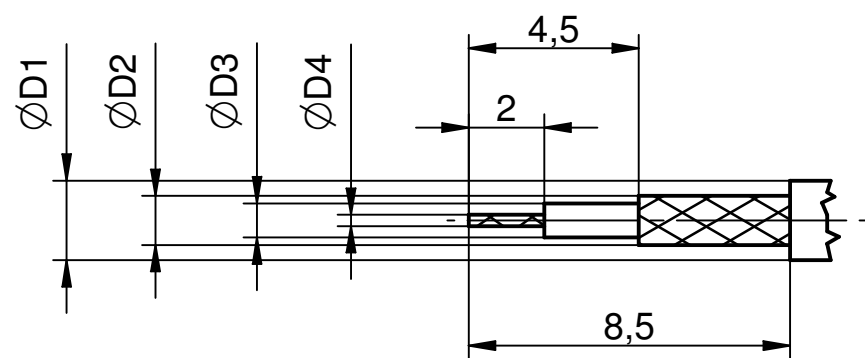

M/s 1:1

Für Kabel/ For cable

Gr.	Type Typ	$\varnothing D1$ max.	$\varnothing D2$ max.	$\varnothing D3$ max.	$\varnothing D4$ max.	$\varnothing D5$	$\varnothing D6$	$\varnothing D7$	$\varnothing D8$	Crimp \varnothing Aussen/out	Innen / in
1	RG 178 BU, RG 196AU,	2,10	1,30	0,90	0,30	1,15	1,70	2,25	3,20	2,67	solder
2	RG 174 BU, RG 316 U	2,80	2,20	1,67	0,54	1,70	2,60	3,20	3,80	3,25	solder
5	RG 316 U-d	3,10	2,50	1,55	0,54	1,70	2,60	3,60	4,30	3,65	solder

IMS CONNECTOR SYSTEMS

general tolerance
ISO 2768
mH
angle: $\pm 5^\circ$

scale: 10:1

Assembly instruction:

Stripping dimension:

date name

generate 03.08.10 Varga A.

checked

Norm

Kabelstecker

Cable mount plug



4293.23.1415.4''

Rev.

nr. rev. alteration date name

cable group surface code