

Kabelzuschnitt
Stripping dimension

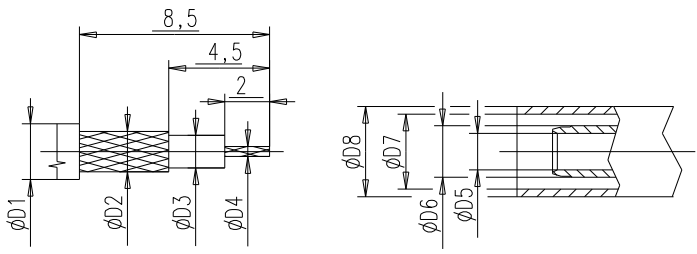

Fuer Kabel /
For cable

Gr.	Type	∅D1 max.	∅D2 max.	∅D3 max.	∅D4 max.	∅D5	∅D6	∅D7	∅D8	Crimp Aussen/out	Crimp Innen/in
1											
2	RG 174 BU; RG 316 U;	2,80	2,20	1,67	0,54	1,70	2,60	3,20	3,80	3,25	solder
3											
4											
5											

2:1

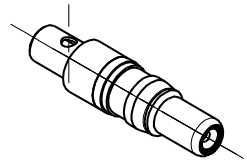

1:1

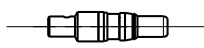

IMS CONNECTOR SYSTEMS

general tolerance
ISO 2768
mH

scale: **10:1**

Assembly instruction: M-6
Stripping dimension: K1

generate	date	name
checked	23.10.07	Schwaer
Norm		
050428		

Kabelbuchse nicht magnetisch
Cable mount jack not magnetic

EC_025_12	a	Housing revised	30.05.12	RSch
nr.	rev.	alteration	date	name

4292.23.2415.42'

Rev. **a**