

Montagebohrungen
Mounting detail

Metallclip
metal clip

X= Measuring point for plating

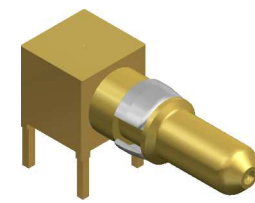

M/s 2:1

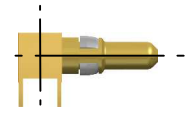

M/s 1:1

		IMS CONNECTOR SYSTEMS			general tolerance ISO 2768 mH angle: ±5°		scale: 10:1	
						Max. Kontaktstrom: 30 A Max. Contact current: 30 A		
EC_105_17	h	revised	14.07.17	mcsenk	date	name	Hochstromwinkelstecker (Voreilend) high power angle insert (pre-engagement)	
EC_027_12	g	revised	02.03.12	lhen	generate	Pfaff		
534/99	f	text added	10.08.99	I.S.	checked	Pözl		
061/99	e	drw. revised	16.02.99	Glatz	Norm		185.24.1025.40' Rev. h	
313/95	d	5,1 to 5,2	16.02.99	Glatz				
	c	R1: min. 2,22	14.02.88	Bär				
	c	6,8-0,5 added	14.02.88	Bär				
	c	18,3 to 18,4	14.02.88	Bär			surface code	
nr.	rev.	alteration	date	name				